

Frenchwood® Hinged Patio Doors Inswing



Section Reference

Table of Basic Sizes	56
Opening Specifications	57
Basic Unit Details	59
Joining Details	59
Standard Divided Light Patterns	67
Sidelights & Transoms	68
Combination Design	70
Performance Data	75

True Andersen classics, these patio doors emphasize beauty and performance. They open inward and, like all Andersen® 400 Series products, are available with a full range of options and accessories.

Features

FRAME

A The sill of the Frenchwood® hinged patio door – inswing is made with three-piece construction. The sub sill is made of vinyl material, and the sill step is solid oak or maple. The exterior sill member is made of extruded aluminum with an attractive wear-resistant, corrosion-resistant, heat-baked finish in a neutral color. This combination of materials combines durability and low maintenance with excellent insulating characteristics.

B All basic exterior frame members are made of a glass fiber reinforced composite, which maintains an attractive appearance while minimizing maintenance. Andersen® Frenchwood hinged patio doors – inswing are available in four neutral colors. Specify White, Sandtone, Terratone® or Forest Green color.

C The exterior frame members are attached to a water-repellent preservative-treated wood subframe for long-lasting* protection and performance.



The subframe is grooved to accept extension jamba.

PANEL

D The exterior of the wood door panel is protected with a long-lasting* urethane base finish in White, Sandtone, Terratone® or Forest Green color.

E Panel interior surfaces are unfinished clear pine. Unfinished oak and maple veneers are available as options. Low-maintenance prefinished white interiors are also available on units with White exteriors.

Hinged inswing operating panels are either left or right-hand active.

F A factory-applied, one-piece compression-type rubber weatherstrip continues in one plane around the panel to provide maximum effectiveness against water and air infiltration. The corners of the weatherstrip are welded to eliminate gaps between the panel and the frame/sill shoulder.

ADJUSTABLE HINGES

Adjustable hinges have ball bearing pivots for smooth, frictionless movement. Features easy horizontal and vertical adjustment, plus quick release feature for easy panel removal. Brass tone finish is standard on wood interior doors. For units with a white prefinished interior, white finish hinges are standard. Also available in factory-applied finishes that coordinate with hardware. Hardware is sold separately.



GLASS

G Panels are silicone bed and back glazed and finished with an interior wood stop and an exterior silicone bead.

H Consult local building codes for glass most suitable to your area. Glass options include:

- Standard High-Performance™ Low-E4® tempered glass (PG Upgrade)
- Standard High-Performance™ Low-E4® Sun tempered glass (PG Upgrade)
- Standard High-Performance™ Low-E4® SmartSun™ tempered glass (PG Upgrade)
- High-Performance™ Low-E4® tempered impact-resistant glass
- High-Performance™ Low-E4® Sun tempered impact-resistant glass
- High-Performance™ Low-E4® SmartSun™ tempered impact-resistant glass

FIVE-POINT LOCKING SYSTEM

I On active/passive door configurations, a five-point lock features stainless steel latches that engage into the sill, head jamb and passive panel for added security and performance.

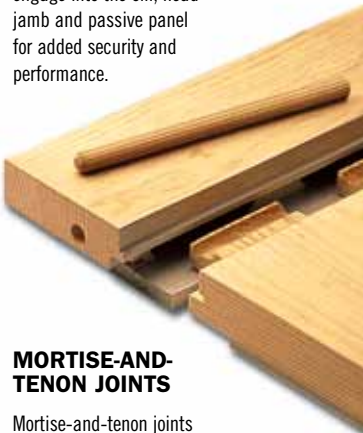

MORTISE-AND-TENON JOINTS

Mortise-and-tenon joints help prevent panel sag and maintain smooth operation.

J All panels feature stainless steel 5-inch screws to reinforce the joints.

* For complete information on our limited warranties, visit andersenwindows.com or contact your Andersen supplier.

Exterior



White Sandtone Terratone® Forest Green

Interior



white pine oak maple

Naturally occurring variations in grain, color and texture make each wood door panel one-of-a-kind.

Specify a unit exterior color option and an interior finish/veneer option to complete your order. Prefinished white interiors are only available on units with white exteriors.

Hardware

Sold Separately.

Albany®



gold dust
black
white
stone

Tribeca®



white
stone

Anvers®



bright brass
satin nickel
oil rubbed bronze

Newbury®

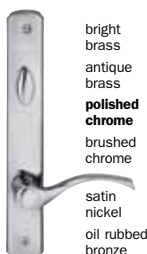

bright brass
antique brass
polished chrome
brushed chrome
satin nickel
oil rubbed bronze

Covington®



bright brass
antique brass
oil rubbed bronze

Whitmore®



bright brass
antique brass
satin nickel
oil rubbed bronze

Encino®



distressed nickel
distressed bronze

Yuma®



distressed nickel
distressed bronze

Hardware Finishes

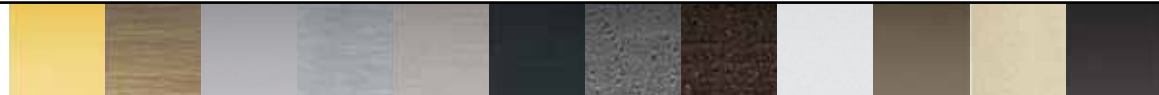

bright brass antique brass polished chrome brushed chrome satin nickel oil rubbed bronze distressed nickel distressed bronze white stone gold dust black

Printing limitations prevent exact color duplication. See your Andersen supplier for actual color samples.

Accessories

Sold Separately.

FRAME

Extension Jambs

Standard jamb depth is 4-9/16" (119). Clear pine, oak or maple veneer or white interior extension jambs are available for the following wall thicknesses:

- 5-1/4" (133)
- 6-9/16" (167)
- 7-1/8" (181)

Bright brass, antique brass, polished chrome, oil rubbed bronze, brushed chrome and satin nickel strike plate extensions are available for single hinge doors.

Exterior extension jamb system is available for the following wall thicknesses:

- 5-1/4" (133)
- 6-9/16" (167)
- 7-9/16" (192)

In walls over 4-1/2" (114), the exterior sill extender and exterior extension jamb system allow the unit to be installed flush to the interior, so the hinged doors will open flat against the interior wall. Colored to match the exterior of the finished unit, this system provides a low-maintenance, finished exterior appearance. An extended double insect screen track is available for double-jamb hinged doors that require gliding insect screens. Exterior jamb kits are available with or without the double-insect screen track.



Threshold

An oak or maple threshold is available for finishing the interior of the sill.



Learn more online at

 andersenwindows.com

Sill Support

An aluminum sill support is designed to lock into a channel under the sill and tie back into the wall. This will offer support to the outermost sill section when needed. Available in neutral gray finish.

Ramped Sill Insert

Provides smooth transition from interior to exterior. Cannot be used with insect screen. Not available on outswing door. (Specifier must check with local and federal officials to determine if product meets accessibility codes.)

HARDWARE

Exterior Keyed Lock

A six-pin exterior key cylinder lock is available for all patio doors in styles and finishes that coordinate with hardware. This lock allows the patio door to be locked and unlocked from the exterior. See page 63 for photo.

Handle Extension Kit

Extends interior door handle an additional 1" (25) from the door panel to accommodate interior blinds or shades. Kit includes one handle extender and spindle. A second extender may be added to the spindle to increase the length an additional 1" (25) (2" (51) total extension). See page 63 for photo.

Hinges

A variety of hinge finishes are available factory-applied, or for after-market installation. Finish options coordinate with handle hardware and are available in bright brass, antique brass, polished chrome, brushed chrome, satin nickel, oil rubbed bronze, distressed nickel, and distressed bronze.

PANEL



Panel Stop

This hinged door panel stop helps prevent wall damage when opening the inswing door. Available in finishes that coordinate with hardware.



Double Insect Screen Track

An extended insect screen track is available for double jamb hinged doors that use gliding insect screens.

SIDELIGHTS AND TRANSOMS



Andersen® Frenchwood® patio door sidelights and transoms feature elegant lines that match our 400 Series Frenchwood hinged patio doors. They feature pine, oak, maple or prefinished white interior options, plus our four standard exterior colors.



Like the doors they complement, Andersen sidelights and transoms are available with Stormwatch® protection. Size information available on pages 68-69.

INSECT SCREENS

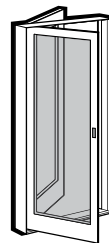

Hinged Insect Screen

Available for single-panel doors.

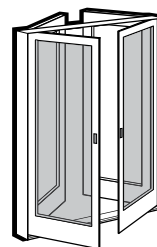

Double-Hinged Insect Screen

Available for two-panel double jamb hinged doors.

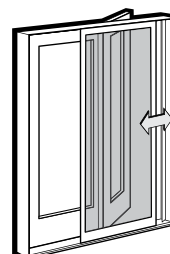

Gliding Insect Screen

Available for all two- and three-panel doors. Features Delrin® material injection molded bottom rollers with self-contained leveling adjusters. A double insect screen track kit and two universal gliding insect screens are required for installation. Gliding insect screens are not available for 4'0" wide doors.

All insect screens are available in White, Sandtone, Terratone® and Forest Green colors.

PG UPGRADES

Frenchwood® Hinged Patio Doors - Inswing

PG Upgrades are available for select sizes only. Ask your Andersen supplier for details.

INSTALLATION ACCESSORIES

See page 6 for information on Andersen's extensive array of installation accessories to help finish out your installation.

GRILLES

Divided Light Patterns

See page 67 for divided light patterns or visit andersenwindows.com/grilles.

GLASS

Andersen® Art Glass

Andersen art glass panels come in eleven original patterns, including four Frank Lloyd Wright® series designs. See the Andersen® Product Guide for details on Andersen art glass, or visit andersenwindows.com/artglass for pattern information.

CAUTION:

- Painting and staining may cause damage to rigid vinyl.
- Products in Sandtone or Terratone® color may be painted any color lighter than Terratone using quality oil-base or latex paint. Submit color samples to Andersen for approval when painting White. Submit color samples to Andersen for approval when painting Sandtone or Terratone any color darker than Terratone.
- Do not paint Forest Green exteriors.
- Creosote-based stains should not come in contact with Andersen products.
- Do not paint weatherstripping.
- Abrasive cleaners or solutions containing corrosive solvents should not be used on Andersen products.
- For vinyl painting instructions and preparation, contact your Andersen supplier.
- Andersen does not warrant the adhesion of paint to vinyl.

NOTE: Andersen® patio doors are not intended for use as entrance doors.

"Frank Lloyd Wright" is a registered trademark of the Frank Lloyd Wright Foundation.

"Delrin" is a registered trademark of E.I. duPont de Nemours and Company.

Table of Basic Unit Sizes Scale 1/8" = 1'-0" (1:96)

Unit Dimension	2'-0 1/2"	4'-0"	4'-0"		
	(620)	(1219)	(1219)		
Minimum Rough Opening	2'-1"	4'-1"	4'-1"		
	(634)	(1242)	(1242)		
Unobstructed Glass	13 3/4"	13 1/4" 13 1/4"	13 1/4" 13 1/4"		
	(336)	(336) (336)	(336) (336)		
Available in 3 heights					
	1 FWH2168S 2 FWH21611S 3 FWH2180S	FWH4168APLR FWH41611APLR FWH4180APLR	FWH4168PALR FWH41611PALR FWH4180PALR	Grille order number: FWH2168 FWH2180 FWH21611	
Unit Dimension	2'-6 1/8"	2'-6 1/8"	2'-6 1/8"	4'-11 1/4"	4'-11 1/4"
	(765)	(765)	(765)	(1504)	(1504)
Minimum Rough Opening	2'-7"	2'-7"	2'-7"	5'-0"	5'-0"
	(787)	(787)	(787)	(1524)	(1524)
Unobstructed Glass	18 7/8"	18 7/8"	18 7/8"	18 7/8" 18 7/8"	18 7/8" 18 7/8"
	(479)	(479)	(479)	(479) (479)	(479) (479)
Available in 3 heights					
	1 FWH2768AR 2 FWH27611AR 3 FWH2780AR	FWH2768AL FWH27611AL FWH2780AL	FWH2768S FWH27611S FWH2780S	FWH5068APLR FWH50611APLR FWH5080APLR	FWH5068PALR FWH50611PALR FWH5080PALR
Unit Dimension	2'-8 1/8"	2'-8 1/8"	2'-8 1/8"	5'-3 1/4"	5'-3 1/4"
	(816)	(816)	(816)	(1607)	(1607)
Minimum Rough Opening	2'-9"	2'-9"	2'-9"	5'-4"	5'-4"
	(838)	(838)	(838)	(1626)	(1626)
Unobstructed Glass	20 7/8"	20 7/8"	20 7/8"	20 7/8" 20 7/8"	20 7/8" 20 7/8"
	(530)	(530)	(530)	(530) (530)	(530) (530)
Available in 3 heights					
	1 FWH2968AR 2 FWH29611AR 3 FWH2980AR	FWH2968AL FWH29611AL FWH2980AL	FWH2968S FWH29611S FWH2980S	FWH5468APLR FWH54611APLR FWH5480APLR	FWH5468PALR FWH54611PALR FWH5480PALR
Unit Dimension	3'-0 1/8"	3'-0 1/8"	3'-0 1/8"	5'-11 1/4"	5'-11 1/4"
	(918)	(918)	(918)	(1810)	(1810)
Minimum Rough Opening	3'-1"	3'-1"	3'-1"	6'-0"	6'-0"
	(940)	(940)	(940)	(1829)	(1829)
Unobstructed Glass	24 7/8"	24 7/8"	24 7/8"	24 7/8" 24 7/8"	24 7/8" 24 7/8"
	(632)	(632)	(632)	(632) (632)	(632) (632)
Available in 3 heights					
	1 FWH3168AR 2 FWH31611AR 3 FWH3180AR	FWH3168AL FWH31611AL FWH3180AL	FWH3168S FWH31611S FWH3180S	FWH6068APLR FWH60611APLR FWH6080APLR	FWH6068PALR FWH60611PALR FWH6080PALR

Three Basic Unit Heights

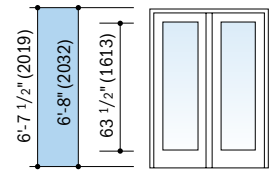

1 FWH xx68

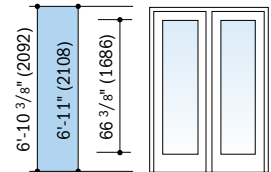

2 FWH xx611

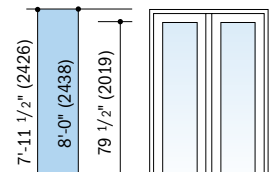

3 FWH xx80

Custom Sizes

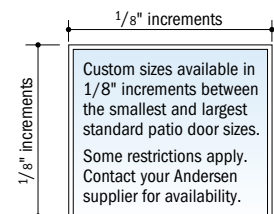

Divided Light Patterns for Patio Doors

In addition to the Colonial grille patterns shown in the table of basic unit sizes, other standard divided light patterns are available. For examples, see page 67 or visit andersenwindows.com/grilles

Prairie pattern

- Rough opening dimensions may need to be increased to allow for use of building wraps, flashing, sill panning, brackets, fasteners or other items. See page 7 for more details.
- "Unit Dimension" always refers to outside frame to frame dimension.
- Andersen® art glass panels are available for all units on this page.
- Dimensions in parentheses are in millimeters.
- Combinations of door units joined together may require horizontal or vertical reinforcement. This reinforcement should be specified by a professional engineer.
- When ordering, be sure to specify color desired: White, Sandtone, Terratone® or Forest Green.
- When ordering, be sure to specify product type: High-Performance™ Low-E4® impact-resistant or PG Upgrade.

Opening Specifications

Frenchwood® Hinged Patio Door – Inswing 6' 8" Height

Unit Number	Sq. Ft. (m ²) Clear Opening	Maximum Clear Opening			Square Feet (m ²) Glass	Square Feet (m ²) Vent	Overall Unit Area Sq. Ft. (m ²)
		Width inches (mm)		Height inches (mm)			
		90°	Full				
2768	12.98 (1.206)	24-13/16" (630)	26" (660)	75-1/4" (1911)	8.32 (0.773)	12.98 (1.206)	16.63 (1.545)
2968	14.02 (1.303)	26-13/16" (681)	28" (711)	75-1/4" (1911)	9.20 (0.855)	14.02 (1.303)	17.74 (1.648)
3168	16.11 (1.497)	30-13/16" (783)	32" (813)	75-1/4" (1911)	10.96 (1.018)	16.11 (1.497)	19.95 (1.853)
4168AP/PA	21.43 (1.991)	41" (1039)	43-7/8" (1112)	75-1/4" (1911)	11.68 (1.085)	21.43 (1.991)	26.50 (2.462)
4168AP/PA (panel closed)	21.43 (1.991)	19-7/8" (505)	21-1/16" (535)	75-1/4" (1911)	11.68 (1.085)	21.43 (1.991)	26.50 (2.462)
5068AP/PA	27.30 (2.536)	52-1/4" (1327)	55-1/8" (1400)	75-1/4" (1911)	16.64 (1.546)	27.30 (2.536)	32.71 (3.039)
5068AP/PA (panel closed)	27.30 (2.536)	25-1/2" (647)	26-11/16" (678)	75-1/4" (1911)	16.64 (1.546)	27.30 (2.536)	32.71 (3.039)
5468AP/PA	29.39 (2.730)	56-1/4" (1429)	59-1/8" (1502)	75-1/4" (1911)	18.39 (1.708)	29.39 (2.730)	34.92 (3.244)
5468AP/PA (panel closed)	29.39 (2.730)	27-1/2" (698)	28-11/16" (729)	75-1/4" (1911)	18.39 (1.708)	29.39 (2.730)	34.92 (3.244)
6068AP/PA	33.58 (3.120)	64-1/4" (1632)	67-1/8" (1705)	75-1/4" (1911)	21.92 (2.036)	33.58 (3.120)	39.34 (3.655)
6068AP/PA (panel closed)	33.58 (3.120)	31-1/2" (800)	32-11/16" (830)	75-1/4" (1911)	21.92 (2.036)	33.58 (3.120)	39.34 (3.655)

Frenchwood® Hinged Patio Door – Inswing 6' 11" Height

Unit Number	Sq. Ft. (m ²) Clear Opening	Maximum Clear Opening			Square Feet (m ²) Glass	Square Feet (m ²) Vent	Overall Unit Area Sq. Ft. (m ²)
		Width inches (mm)		Height inches (mm)			
		90°	Full				
27611	13.48 (1.252)	24-13/16" (630)	26" (660)	78-1/8" (1984)	8.69 (0.807)	13.48 (1.252)	17.21 (1.599)
29611	14.55 (1.352)	26-13/16" (681)	28" (711)	78-1/8" (1984)	9.61 (0.893)	14.55 (1.352)	18.36 (1.706)
31611	16.72 (1.553)	30-13/16" (783)	32" (813)	78-1/8" (1984)	11.45 (1.064)	16.72 (1.553)	20.64 (1.918)
41611AP/PA	22.24 (2.066)	41" (1039)	43-7/8" (1112)	78-1/8" (1984)	12.20 (1.133)	22.24 (2.066)	27.46 (2.551)
41611AP/PA (panel closed)	22.24 (2.066)	19-7/8" (505)	21-1/16" (535)	78-1/8" (1984)	12.20 (1.133)	22.24 (2.066)	27.46 (2.551)
50611AP/PA	28.34 (2.633)	52-1/4" (1327)	55-1/8" (1400)	78-1/8" (1984)	17.38 (1.615)	28.34 (2.633)	33.89 (3.148)
50611AP/PA (panel closed)	28.34 (2.633)	25-1/2" (647)	26-11/16" (678)	78-1/8" (1984)	17.38 (1.615)	28.34 (2.633)	33.89 (3.148)
54611AP/PA	30.51 (2.834)	56-1/4" (1429)	59-1/8" (1502)	78-1/8" (1984)	19.22 (1.786)	30.51 (2.834)	36.18 (3.361)
54611AP/PA (panel closed)	30.51 (2.834)	27-1/2" (698)	28-11/16" (729)	78-1/8" (1984)	19.22 (1.786)	30.51 (2.834)	36.18 (3.361)
60611AP/PA	34.86 (3.239)	64-1/4" (1632)	67-1/8" (1705)	78-1/8" (1984)	22.91 (2.128)	34.86 (3.239)	40.76 (3.787)
60611AP/PA (panel closed)	34.86 (3.239)	31-1/2" (800)	32-11/16" (830)	78-1/8" (1984)	22.91 (2.128)	34.86 (3.239)	40.76 (3.787)

Clear Opening Dimensions Scale 1-1/2" = 1'-0" (1:8)

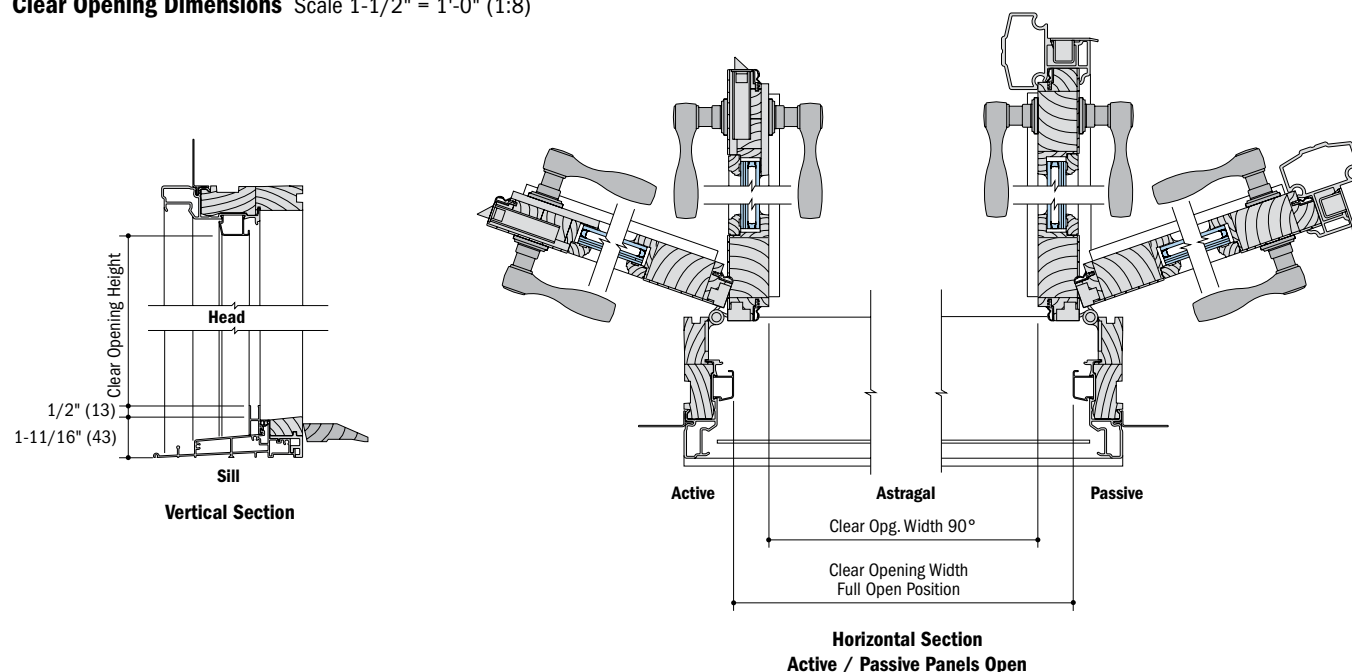

Opening Specifications

Frenchwood® Hinged Patio Door – Inswing 8' 0" Height

Unit Number	Sq. Ft. (m²) Clear Opening	Maximum Clear Opening			Square Feet (m²) Glass	Square Feet (m²) Vent	Overall Unit Area Sq. Ft. (m²)
		Width inches (mm)	Height inches (mm)	Height inches (mm)			
2780	15.73 (1.461)	24-13/16" (630)	26" (660)	91-1/4" (2318)	10.41 (0.967)	15.73 (1.461)	19.98 (1.856)
2980	17.00 (1.579)	26-13/16" (681)	28" (711)	91-1/4" (2318)	11.52 (1.070)	17.00 (1.579)	21.31 (1.980)
3180	19.54 (1.815)	30-13/16" (783)	32" (813)	91-1/4" (2318)	13.72 (1.275)	19.54 (1.815)	23.96 (2.226)
4180AP/PA	25.98 (2.414)	41" (1039)	43-7/8" (1112)	91-1/4" (2318)	14.62 (1.358)	25.98 (2.414)	31.83 (2.957)
4180AP/PA (panel closed)	25.98 (2.414)	19-7/8" (505)	21-1/16" (535)	91-1/4" (2318)	14.62 (1.358)	25.98 (2.414)	31.83 (2.957)
5080AP/PA	33.11 (3.076)	52-1/4" (1327)	55-1/8" (1400)	91-1/4" (2318)	20.82 (1.934)	33.11 (3.076)	39.30 (3.651)
5080AP/PA (panel closed)	33.11 (3.076)	25-1/2" (647)	26-11/16" (678)	91-1/4" (2318)	20.82 (1.934)	33.11 (3.076)	39.30 (3.651)
5480AP/PA	35.64 (3.311)	56-1/4" (1429)	59-1/8" (1502)	91-1/4" (2318)	23.03 (2.140)	35.64 (3.311)	41.95 (3.897)
5480AP/PA (panel closed)	35.64 (3.311)	27-1/2" (698)	28-11/16" (729)	91-1/4" (2318)	23.03 (2.140)	35.64 (3.311)	41.95 (3.897)
6080AP/PA	40.71 (3.782)	64-1/4" (1632)	67-1/8" (1705)	91-1/4" (2318)	27.44 (2.549)	40.71 (3.782)	47.25 (4.390)
6080AP/PA (panel closed)	40.71 (3.782)	31-1/2" (800)	32-11/16" (830)	91-1/4" (2318)	27.44 (2.549)	40.71 (3.782)	47.25 (4.390)

Unit Identification

Units viewed from the exterior

Basic Hinging

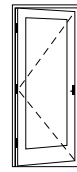

Left Hinged
Hinges mounted on the left side of the panel.



Right Hinged
Hinges mounted on the right side of the panel.

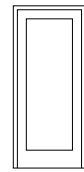

Stationary Panel
Non-operating panel.

Double Jamb Hinged Door

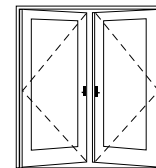

Active Panel
The operating panel most often used.

Passive Panel
The operating panel with astragal attached.

Order Designation Description

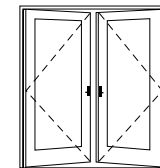

FWH Frenchwood® hinged door (Inswing)
6068 Door rough opg.
A Active panel
P Passive panel
L Left hinged
R Right hinged

Center Line Astragal Dimensions

4-1 WIDTHS	2'-0" (610)	2'-0" (610)
5-0 WIDTHS	2'-5 5/8" (752)	2'-5 5/8" (752)
5-4 WIDTHS	2'-7 5/8" (803)	2'-7 5/8" (803)
6-0 WIDTHS	2'-11 5/8" (897)	2'-11 5/8" (897)

Clear Opening Dimensions Scale 1-1/2" = 1'-0" (1:8)

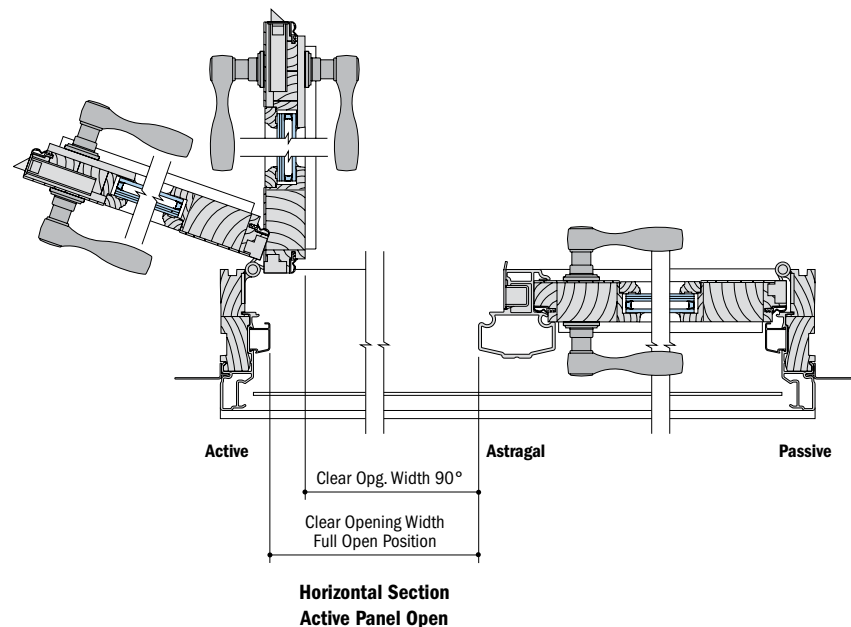

Basic Unit and Rough Opening Details Scale 1-1/2" = 1'-0" (1:8)

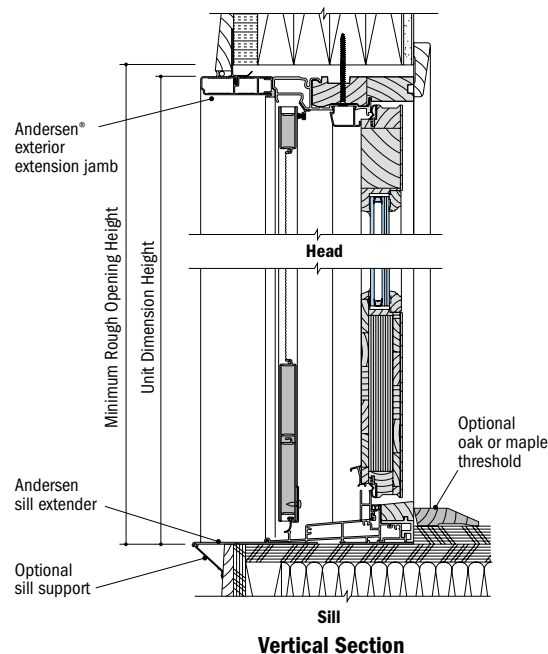
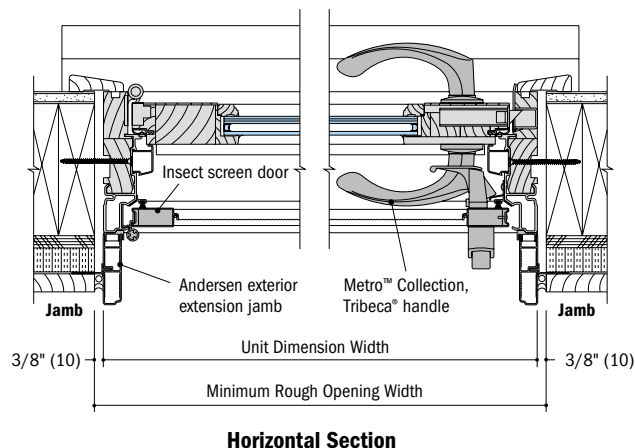

Joining Details Scale 1-1/2" = 1'-0" (1:8)

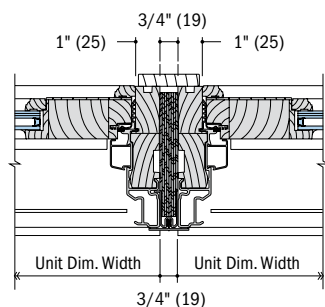

Andersen® LVL Reinforced Mullion

Overall Unit Dimension Width:

The sum of individual Unit Dimension Widths, plus 3/4" (19mm) for each unit joining.

Overall Rough Opening Width:

Add 3/4" (19mm) to Overall Unit Dimension Width.

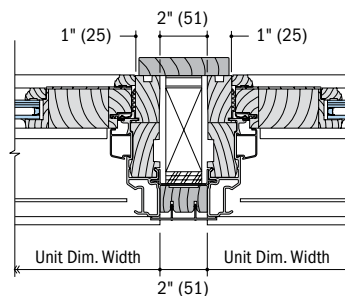

Support Mullion

Overall Unit Dimension Width:

Sum of individual Unit Dimension Widths, plus 2" (51mm) for each unit joining.

Overall Rough Opening Width:

Add 3/4" (19mm) to Overall Unit Dimension Width.

Consult with an architect or structural engineer regarding minimum requirements for structural support members between adjacent door rough openings.

Ramped Sill Details Scale 1-1/2" = 1'-0" (1:8)

Note:
Cannot be used with insect screen.

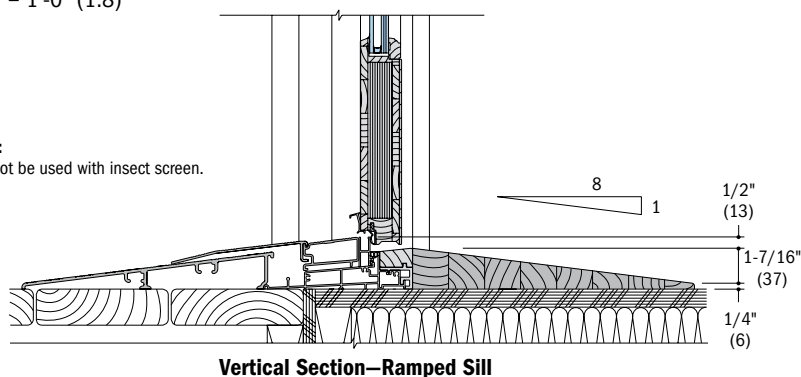

Basic Unit Details Scale 1-1/2" = 1'-0" (1:8)

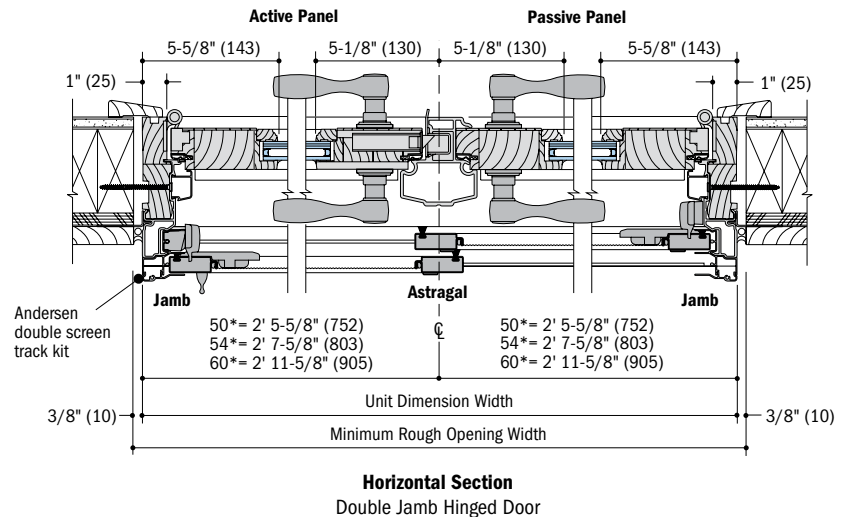
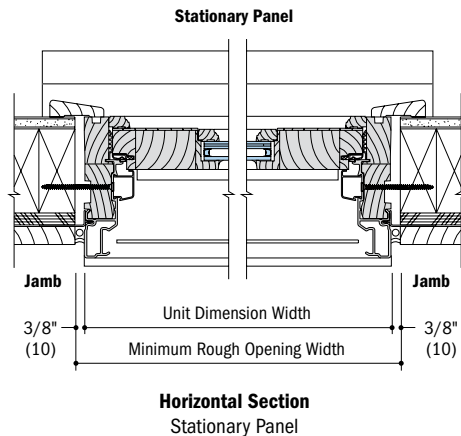

- * These dimensions relate to location of astragal center line.
- * Rough opening dimensions may need to be increased to allow for use of building wraps, flashing, sill panning, brackets, fasteners or other items. See page 7 for more details.

Suggested Product Applications Scale 1-1/2" = 1'-0" (1:8)

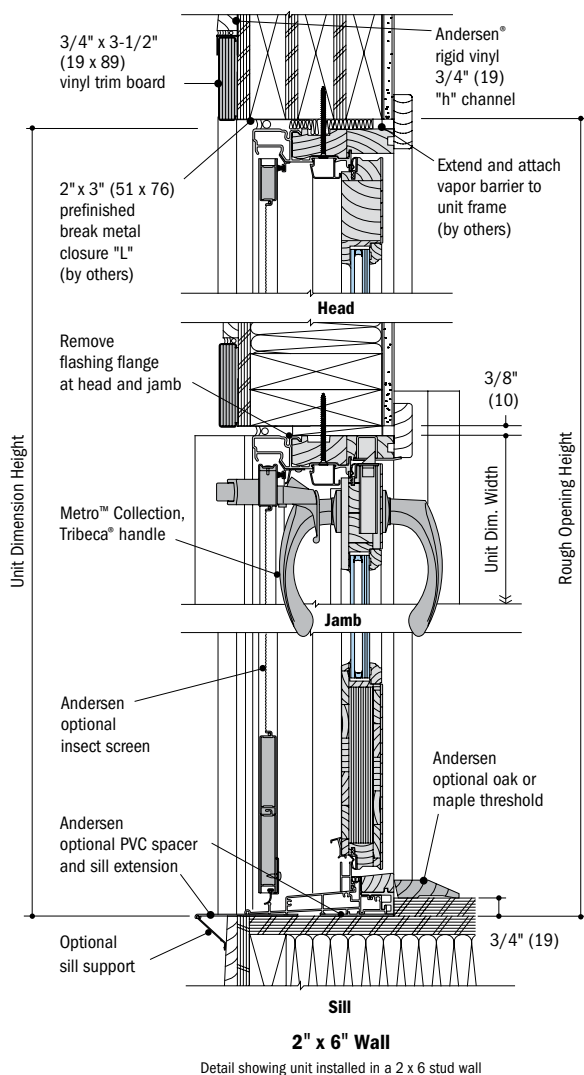

Interior Extension Jamb

The use of interior extension jambs or drywall return will restrict panel operation on jamb hinged doors. Jamb hinged patio doors must be installed flush to the interior to achieve full panel operation.

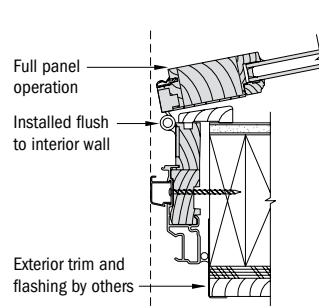

Jamb hinged patio door in 2" x 6" wall without extension jambs

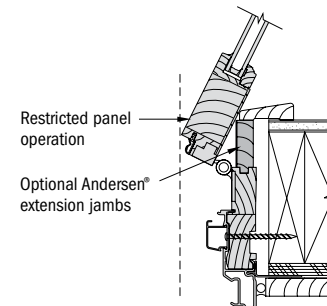

Jamb hinged patio door in 2" x 6" wall with extension jambs

Proper installation and maintenance of Andersen products is essential to attain optimum performance and operation. Written installation instructions which provide guidelines for proper installation are typically provided with Andersen products. They are also available from your local Andersen supplier or by visiting andersenwindows.com. Remember that every installation is different, and Andersen strongly recommends consultation with the local supplier or an experienced contractor, architect or structural engineer prior to the installation of any Andersen product. The method of attachment for Andersen products, fastener selection and code compliance is the responsibility of the architect, building owner, contractor, installer and/or consumer. For complete installation details, refer to "Product Installation Details" at andersenwindows.com or contact your Andersen supplier.

NOTE: See installation information starting on page 6.

CAUTION: In masonry wall construction, provide a minimum of 1/2" clearance from the top of the brick or masonry to the bottom of any portion of the sill. Failure to do so could result in product damage. Fill the void with closed cell foam backer rod and silicone sealant. Be sure to allow for dimensional change of framework.